

NOTICE OF MINERAL TITLE APPLICATIONS OVER ABORIGINAL LAND

MINERAL TITLES ACT 2010 SECTION 71

Objections/Submissions to Mineral Title applications (s71 [3])

The landowner(s) of land in respect of which the following applications are made may lodge an objection to the grant of the application; any other persons may lodge a submission. Objections and submissions must be lodged in writing to the Department of Industry, Tourism and Trade, GPO Box 4550, DARWIN NT 0801 or emailed to titles.info@nt.gov.au. Objections and submissions can also be lodged at Centrepont Building, 48-50 Smith Street, Darwin, within 30 days from the relevant Notification Date, which is set out below.

Exploration Licence 32444 sought by ELAINE BOHNING, GARY BOHNING AND RED DINGO CORP PTY LTD, ACN 161 336 081 over an area of 28 Blocks (68 km²) depicted below for a term of 6 years, within the RIDDOCH locality.

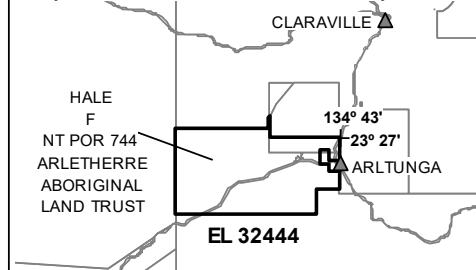

Not To Scale NMIG Map Sheet No: 5851

Exploration Licence 32393 sought by CERBERUS RESOURCES PTY LTD, ACN 615 192 535 over an area of 250 Blocks (793 km²) depicted below for a term of 6 years, within the REDVERS locality.

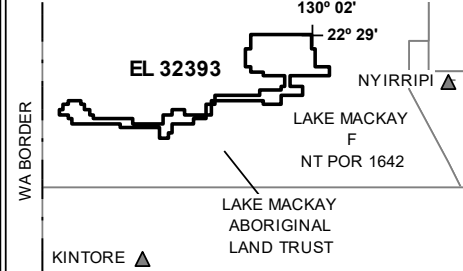

Not To Scale NMIG Map Sheet No: 4852

Exploration Licence 32394 sought by CERBERUS RESOURCES PTY LTD, ACN 615 192 535 over an area of 250 Blocks (795 km²) depicted below for a term of 6 years, within the NICKER locality.

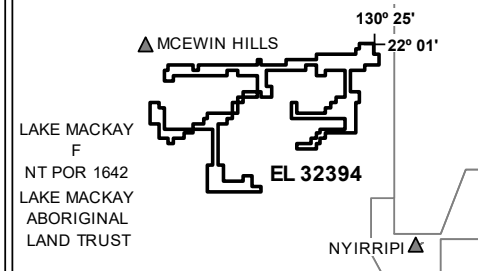

Not To Scale NMIG Map Sheet No: 4953

Exploration Licence 32431 sought by CERBERUS RESOURCES PTY LTD, ACN 615 192 535 over an area of 116 Blocks (367 km²) depicted below for a term of 6 years, within the CHALUBA locality.

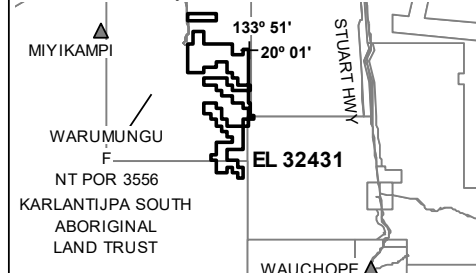

Not To Scale NMIG Map Sheet No: 5657

Exploration Licence 32399 sought by JACKSON CAGE PTY LTD, ACN 614 042 189 over an area of 10 Blocks (12 km²) depicted below for a term of 6 years, within the MT WEDGE locality.

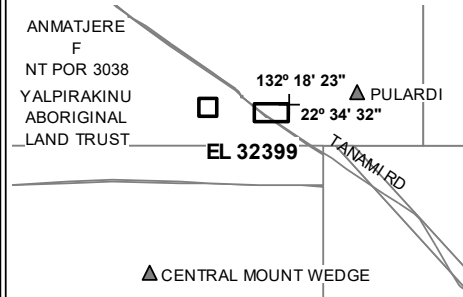

Not To Scale NMIG Map Sheet No: 5352

Exploration Licence 32397 sought by PAYNE GULLY GOLD PTY LTD, ACN 638 017 731 over an area of 32 Blocks (78 km²) depicted below for a term of 6 years, within the TENNANT CREEK locality.

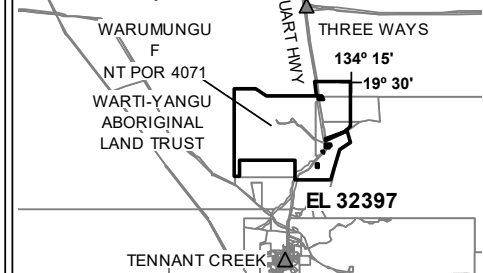

Not To Scale NMIG Map Sheet No: 5758

Exploration Licence 32398 sought by PAYNE GULLY GOLD PTY LTD, ACN 638 017 731 over an area of 81 Blocks (255 km²) depicted below for a term of 6 years, within the TENNANT CREEK locality.

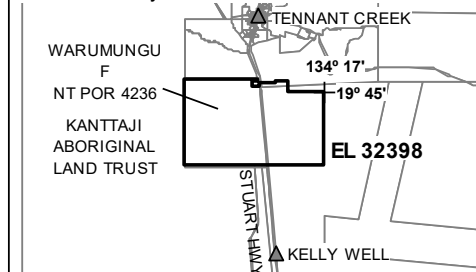

Not To Scale NMIG Map Sheet No: 5758

Exploration Licence 32409 sought by PAYNE GULLY GOLD PTY LTD, ACN 638 017 731 over an area of 46 Blocks (145 km²) depicted below for a term of 6 years, within the KELLY locality.

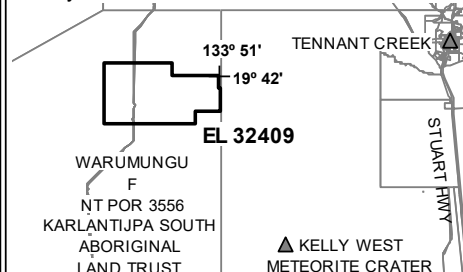

Not To Scale NMIG Map Sheet No: 5658

Exploration Licence 32410 sought by PAYNE GULLY GOLD PTY LTD, ACN 638 017 731 over an area of 106 Blocks (332 km²) depicted below for a term of 6 years, within the GOSSE RIVER locality.

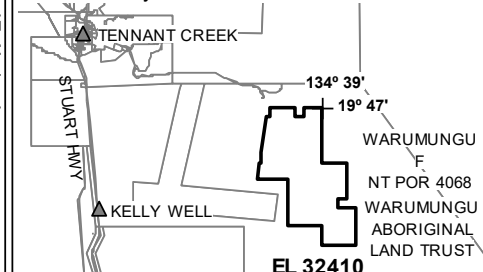

Not To Scale NMIG Map Sheet No: 5658

Notification Date: 30 September 2020