

**MN125/20**

**DARWIN**

**22 December 2020**

**Mineral Titles Act 2010  
NOTICE OF LAND CEASING TO BE A MINERAL TITLE  
APPLICATION AREA**

Title Type and Number: Extractive Mineral Exploration Licence 32377  
 Area Ceased on: 21 December 2020  
 Area: 4 Blocks, 13.35 km<sup>2</sup>  
 Locality: PINE CREEK  
 Name of Applicant(s)/Holder(s): 100% BRIDGE CREEK SAND MINING PTY LTD [ACN. 639 190 873]

**492/20**

**Mineral Titles Act 2010  
NOTICE OF LAND CEASING TO BE A MINERAL TITLE  
APPLICATION AREA**

Title Type and Number: Extractive Mineral Exploration Licence 32379  
 Area Ceased on: 21 December 2020  
 Area: 4 Blocks, 13.35 km<sup>2</sup>  
 Locality: PINE CREEK  
 Name of Applicant(s)/Holder(s): 100% BRIDGE CREEK SAND MINING PTY LTD [ACN. 639 190 873]

**494/20**

**Mineral Titles Act 2010  
NOTICE OF LAND CEASING TO BE A MINERAL TITLE  
APPLICATION AREA**

Title Type and Number: Extractive Mineral Exploration Licence 32378  
 Area Ceased on: 21 December 2020  
 Area: 4 Blocks, 13.35 km<sup>2</sup>  
 Locality: PINE CREEK  
 Name of Applicant(s)/Holder(s): 100% BRIDGE CREEK SAND MINING PTY LTD [ACN. 639 190 873]

**493/20**

**Mineral Titles Act 2010  
NOTICE OF LAND CEASING TO BE A MINERAL TITLE  
APPLICATION AREA**

Title Type and Number: Extractive Mineral Exploration Licence 32380  
 Area Ceased on: 21 December 2020  
 Area: 4 Blocks, 13.35 km<sup>2</sup>  
 Locality: PINE CREEK  
 Name of Applicant(s)/Holder(s): 100% BRIDGE CREEK SAND MINING PTY LTD [ACN. 639 190 873]

**495/20**

**MN125/20**

**DARWIN**

**22 December 2020**

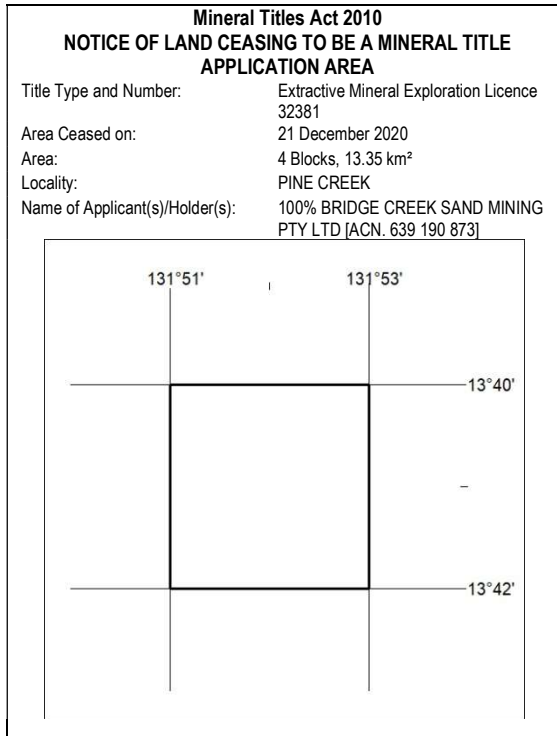

**496/20**

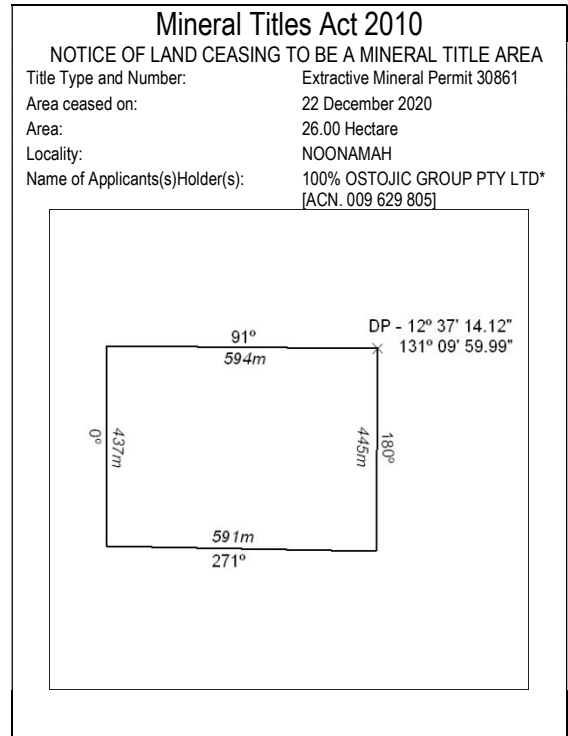

**498/20**

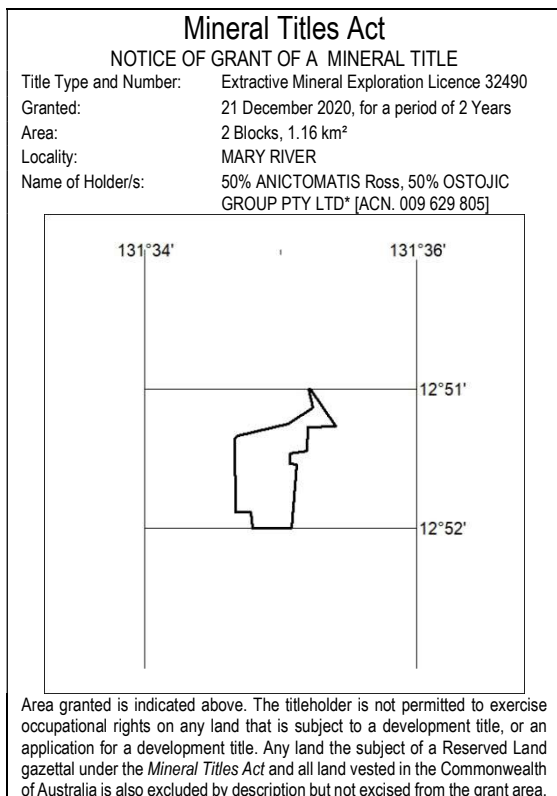

**497/20**