

NOTICE OF MINERAL TITLE APPLICATIONS

MINERAL TITLES ACT 2010 SECTION 71

Objections or Submissions to mineral title applications (s71 [3])

The landowner(s) of land in respect of which the following applications are made may lodge an objection to the grant of the application; any other persons may lodge a submission. Objections and submissions must be lodged in writing to the Department of Industry, Tourism and Trade, GPO Box 4550, DARWIN NT 0801 or emailed to titles.info@nt.gov.au. Objections and submissions can also be lodged at Centrepoint Building, 48-50 Smith Street, Darwin, within 30 days from the relevant Notification Date, which is set out below.

Extractive Mineral Exploration Licence 32655 sought by TERRITORY SANDS PTY LTD, ACN 632 797 972 over an area of 4 Blocks (14 km²) depicted below for a term of 2 years, within the NEWCASTLE WATERS locality.

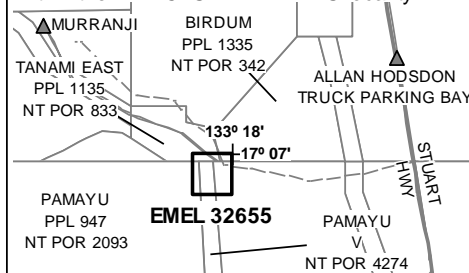

Not To Scale NMIG Map Sheet No: 5563

Extractive Mineral Exploration Licence 32656 sought by TERRITORY SANDS PTY LTD, ACN 632 797 972 over an area of 4 Blocks (14 km²) depicted below for a term of 2 years, within the NEWCASTLE WATERS locality.

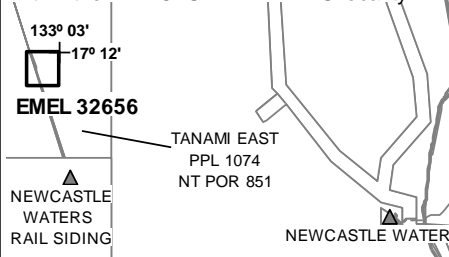

Not To Scale NMIG Map Sheet No: 5563

Extractive Mineral Exploration Licence 32657 sought by TERRITORY SANDS PTY LTD, ACN 632 797 972 over an area of 4 Blocks (14 km²) depicted below for a term of 2 years, within the NEWCASTLE WATERS locality.

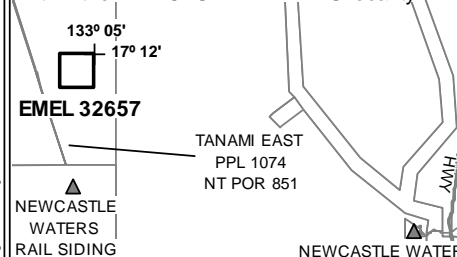

Not To Scale NMIG Map Sheet No: 5563

Extractive Mineral Exploration Licence 32658 sought by TERRITORY SANDS PTY LTD, ACN 632 797 972 over an area of 4 Blocks (14 km²) depicted below for a term of 2 years, within the DRY RIVER locality.

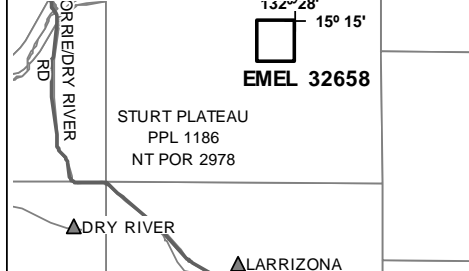

Not To Scale NMIG Map Sheet No: 5367

Extractive Mineral Exploration Licence 32659 sought by TERRITORY SANDS PTY LTD, ACN 632 797 972 over an area of 4 Blocks (14 km²) depicted below for a term of 2 years, within the DRY RIVER locality.

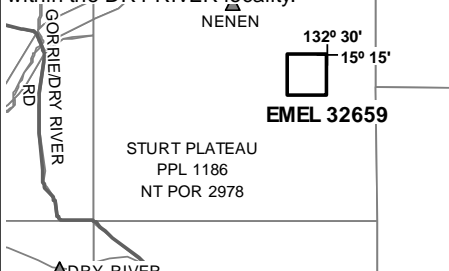

Not To Scale NMIG Map Sheet No: 5367

Extractive Mineral Exploration Licence 32660 sought by TERRITORY SANDS PTY LTD, ACN 632 797 972 over an area of 4 Blocks (14 km²) depicted below for a term of 2 years, within the ELSEY locality.

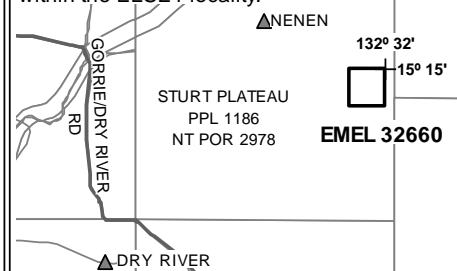

Not To Scale NMIG Map Sheet No: 5467

Extractive Mineral Exploration Licence 32661 sought by TERRITORY SANDS PTY LTD, ACN 632 797 972 over an area of 4 Blocks (14 km²) depicted below for a term of 2 years, within the NEWCASTLE WATERS locality.

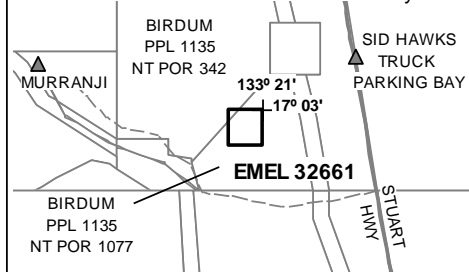

Not To Scale NMIG Map Sheet No: 5563

Extractive Mineral Exploration Licence 32662 sought by TERRITORY SANDS PTY LTD, ACN 632 797 972 over an area of 4 Blocks (14 km²) depicted below for a term of 2 years, within the MURRANJ I locality.

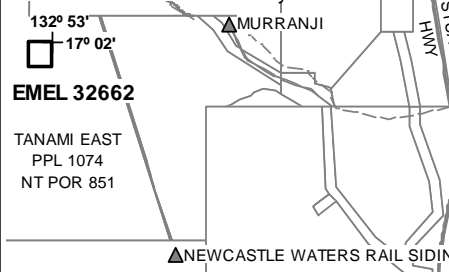

Not To Scale NMIG Map Sheet No: 5463

Extractive Mineral Exploration Licence 32663 sought by TERRITORY SANDS PTY LTD, ACN 632 797 972 over an area of 4 Blocks (14 km²) depicted below for a term of 2 years, within the MURRANJ I locality.

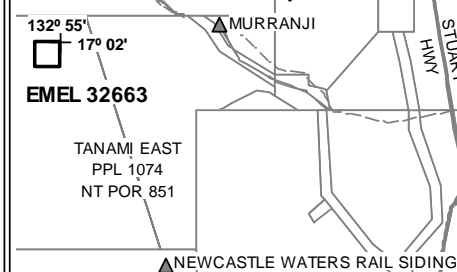

Not To Scale NMIG Map Sheet No: 5463

Notification Date: 12 May 2021